



Grease Guardian separates and removes grease, oil and fat from kitchen wastewater

HOW IT WORKS

- Wastewater enters the unit through a removable strainer basket which captures solid debris
- In the chamber, the lighter oils and grease rise to the surface while the now-separated water exits from the unit. Tests have shown that the Grease Guardian is 97% to 98% effective in separating oils and grease from water
- An in-built heater is set to the requirements of each installation to ensure that the oils and grease do not solidify
- A motor-operated skimming wheel collects the oils and grease electrostatically, then transfers them to the outlet pipe via a wiper-blade system
- The skimmed oils and grease are collected in an external container, ready for collection by a renderer or recycler
- Model D1 is available in IP66 rating against the ingress of water, meaning that it can be cleaned down with high-pressure water jets

APPLICATIONS

- Where a grease trap is too small by current standards and cannot be physically extended
- Where chickens are barbecued in bulk and the Water Authority requires that a grease interceptor be installed up-stream of the grease trap
- Where no grease trap exists in the premises and it is impossible, impractical or cost-prohibitive to build one
- Where a landlord will not grant permission for a grease trap to be installed
- Generally, Water Authority approval is required before a Grease Guardian can be installed. Please ask Eco Guardians to assist you with your submission

**Model D1 - Left to Right: plumbing/electrical
Standard arrangement: front view**

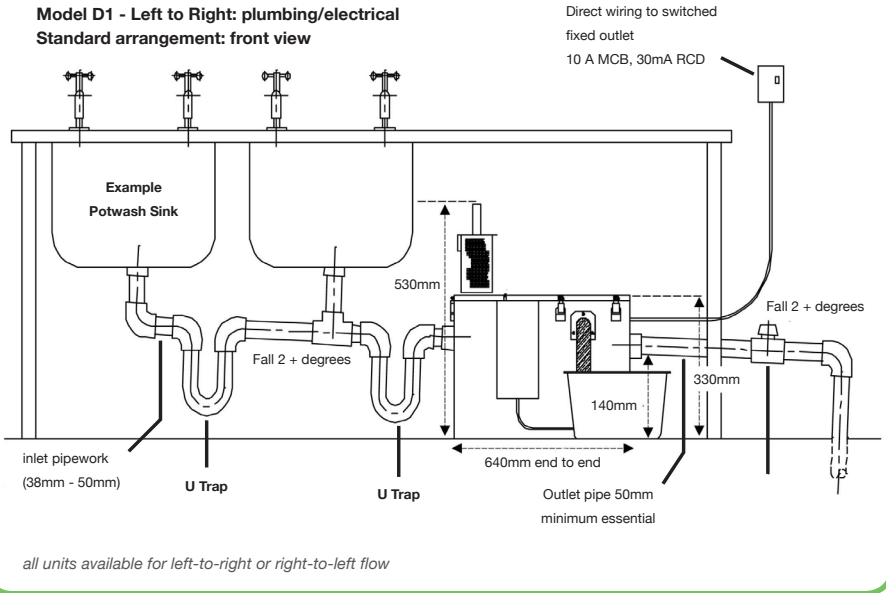

Specifications

- Casing Material**
16 Gauge, 304 Stainless Steel
- Skimming Rate**
Each wheel is capable of skimming 12kg per hour of grease/oil
An extra wheel can be included for heavier grease/oil content
- Timer**
230v, 50Hz, BEAB Approved
24-Hour Operation
- Motor**
25 Watt, 230v, 50Hz, Thermally Protected,
1.3 µF Capacitor

Sizing Guide

| Seating Capacity | Flow Rate Litres/day | Model Number | Equivalent Interceptor |
|------------------|----------------------|--------------|------------------------|
| 0 to 69 | 1,100 litres | D1 | 1100 litres |
| 70 to 199 | 3,200 litres | D2 | 2000 litres |
| 200 to 399 | 6,400 litres | D3 | 2500 litres |
| 400 to 599 | 9,600 litres | D4 | 3000 litres |
| 600 to 799 | 12,800 litres | D5 | 4000 litres |

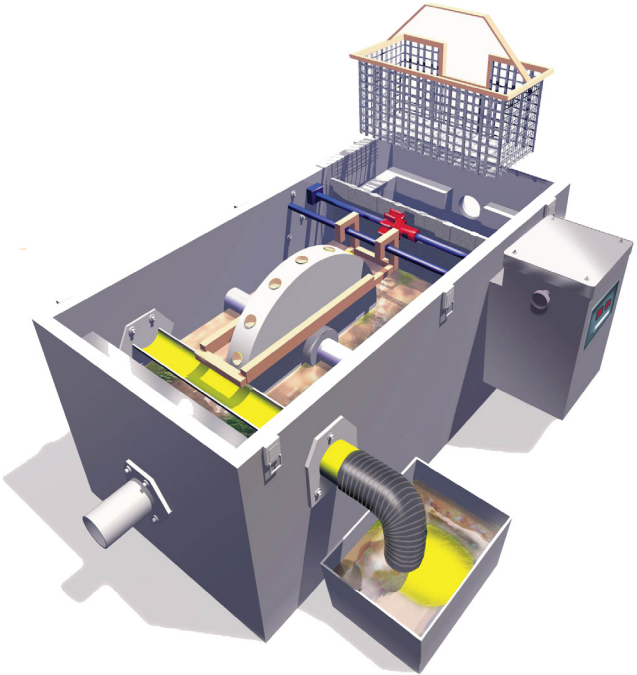

Dimensions

| Model | D1 | D2 | D3 | D4 | D5 |
|---------------|------|------|------|------|------|
| Length | 640 | 720 | 840 | 890 | 1420 |
| Width* | 310 | 310 | 310 | 310 | 310 |
| Height | 330 | 410 | 450 | 450 | 460 |
| Clearance** | 200 | 240 | 270 | 270 | 270 |
| Inlet/Outlet | 50 | 50 | 90 | 115 | 115 |
| Max. Flow l/s | 0.75 | 1.25 | 1.75 | 2.25 | 3.50 |

Dimensions shown in mm
*Excluding grease collection container
**Clearance above unit for removal of basket



www.ecoguardians.com.au
info@ecoguardians.com.au

Eco Guardians Pty Ltd
90 St Kilda Rd, St Kilda.
Victoria, 3182, Australia

All units comply with the Health, Safety & Electrical requirements of the machinery Director 98/37EC and carry the "CE" mark

FREE CALL 1300 556 628